

PREMIUM

10.0T

Tcoil



RECHARGEABLE

Hearing  
INSTRUMENTS



USER GUIDE

For more information, please visit the Kirkland Signature™ 10.0 (KS 10.0) User Portal at [www.KS10userportal.com](http://www.KS10userportal.com).

This user guide is valid for:

**Wireless hearing aids**

KS 10.0

KS 10.0 Demo

KS 10.0 Loaner

**CE mark applied**

2020

2020

2020

**Non wireless charging accessories**

Kirkland Signature Charger Case

Easy Line Power Pack

**CE mark applied**

2020

2016



## Your hearing aid details

- ① If no box is checked and you do not know the model of your hearing aid or charging accessories, please ask your hearing care professional.
- ① The hearing aids described in this user guide contain a built-in and non-removable rechargeable lithium-ion battery.
- ① The Easy Line Power Pack contains a built-in and non-removable rechargeable lithium-polymer battery.
- ① Please also read safety information regarding handling rechargeable hearing aids (chapter 23).

**Hearing aid model**

KS 10.0

**Earpieces**

- ☐ Dome
- ☐ SlimTip
- ☐ cShell

These premium products are the result of decades of research and expertise, and are designed to keep you connected to the beauty of sound! We thank you for making such a great choice and wish you many years of listening pleasure.

**Charging accessories**

- ☐ Kirkland Signature Charger Case\*
- ☐ Easy Line Power Pack

Please read the user guide carefully to make sure that you understand and get the most out of your hearing aids. For more information about features and benefits, simply contact your hearing care professional.

[www.KS10userportal.com](http://www.KS10userportal.com)

\* Incl. power supply and USB cable (< 3 m)

# Contents

<b>Your hearing aid and charger</b>			
1. Quick guide	8	12. Initial pairing	37
2. Parts of the hearing aid & charger	12	13. Phone calls	41
<b>Using the charger</b>		14. Flight mode	46
3. Preparing the charger	18	15. Rebooting your hearing aid	49
4. Charging the hearing aids	20	<b>Further information</b>	
<b>Using the hearing aid</b>		16. Operating, transport and storage conditions	51
5. Left & right hearing aid markings	29	17. Care and maintenance	54
6. Putting on the hearing aid	30	18. Exchanging the earwax protection	58
7. Removing the hearing aid	31	19. Service and warranty	63
8. Multifunction button	32	20. Compliance information	65
9. On/Off	33	21. Information and description of symbols	73
10. Touch control	35	22. Troubleshooting	82
11. Connectivity overview	36	23. Important safety information	90
		24. Important information: Cellphones	109
		25. For the U.S. market only, complies with the FDA regulations	111

# 1. Quick guide

## Charging your hearing aids

- ❶ Before using your hearing aid for the first time, it is recommended to charge it for 3 hours.

After placing your hearing aid in the charger, the indicator light will show the charging state of the battery until the hearing aid is fully charged. When fully charged the indicator light will be constantly on, i.e. solid green light.



## Left & right hearing aid markings

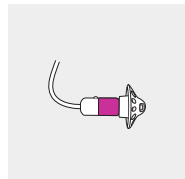
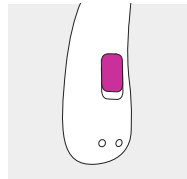

Blue marking for **left** hearing aid.  
Red marking for **right** hearing aid.

## Multifunction button with indicator light

The button has several functions. It functions as an on/off switch, a volume control and/or a program change depending on the hearing aid programming. This is indicated in your individual instructions.

**Phone calls:** If paired with a Bluetooth® enabled phone, a short press will accept and a long press will reject an incoming call.

**On/Off:** Firmly press the lower part of the button for 3 seconds until the indicator light blinks.

On: indicator light is solid green

Off: indicator light is solid red

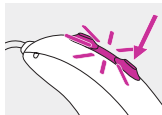

**Enter flight mode:** When device is off, press the lower part of the button for 7 seconds until the solid orange light appears. Then release the button.

## Touch Control

If paired with a Bluetooth enabled device, multiple functions can be accessed using the touch control, please refer to chapter 10. This is also indicated in your individual instructions.

To use this function tap the top of your ear twice.

## 2. Parts of the hearing aid & charger

The following pictures show the hearing aid model and charger accessories described in this user guide.

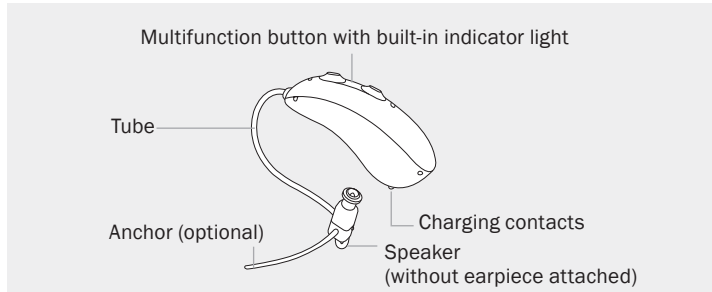

### Possible earpieces

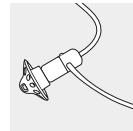

Dome

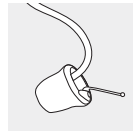

SlimTip

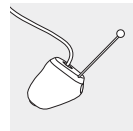

cShell

## Kirkland Signature Charger Case

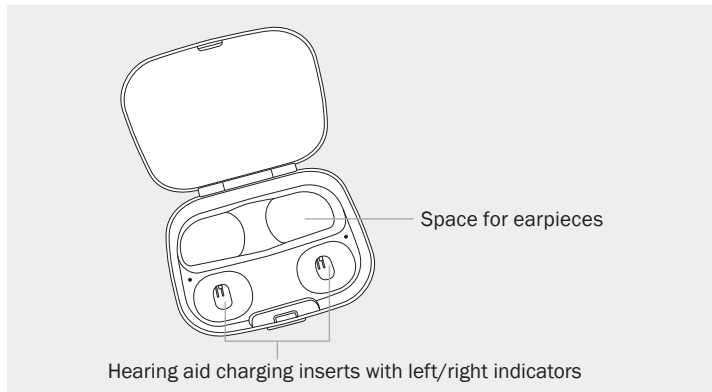

## Kirkland Signature Charger Case with optional Easy Line Power Pack

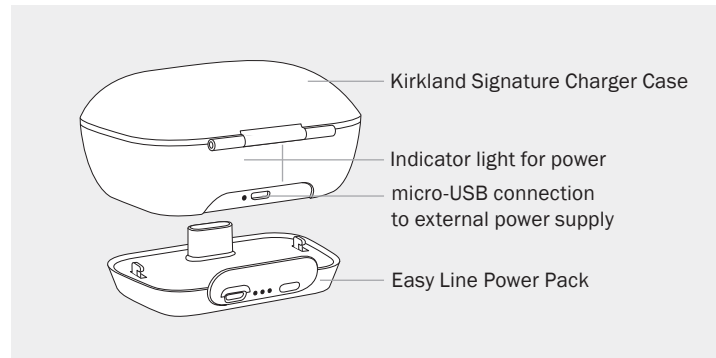



micro-USB connection to external power supply

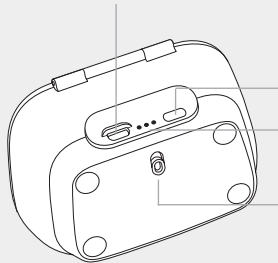

Battery check button

Indicator light for battery status  
and external power

Easy Line Power Pack  
lock and release

## External power supply



USB cable (< 3 m)

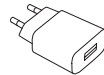

Power supply

### 3. Preparing the charger

#### Connecting the power supply

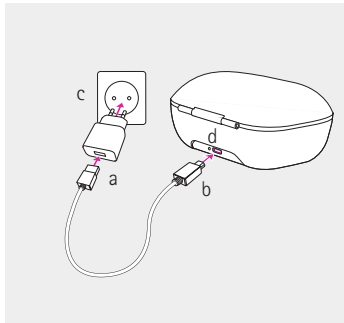

- a) Plug the larger end of the charging cable into the power supply.
- b) Plug the smaller end into the USB port on the charger.
- c) Plug the power supply into a power outlet.
- d) The indicator light is green when the charger is connected to the power supply.

#### Power supply specification

---

Power supply output voltage	5 VDC +/-10%, current 1 A
Charger input voltage	5 VDC +/-10%, current 1 A
USB cable specifications	5 V min. 1 A, USB-A to USB-C, maximum length 3 m

## 4. Charging the hearing aids

- ❗ Low power: You will hear two beeps when the battery is low. You will have approximately 60 minutes before you have to charge the hearing aids (this can vary, depending on the hearing aid settings).
- ❗ The hearing aid contains a built-in and non-removable rechargeable lithium-ion battery.
- ❗ Before using your hearing aid for the first time, it is recommended to charge it for 3 hours.
- ❗ The hearing aid must be dry before charging, see chapter 17.
- ❗ Please ensure to charge and use the hearing aid within operating temperature range: +5° to +40° Celsius (41° to 104° Fahrenheit).

### 4.1 Using the Kirkland Signature Charger Case

Please refer to chapter 3 for how to set up the charger.

1

Insert the hearing aid into the charging inserts. Make sure the left and right hearing aid markings match the left (blue), right (red) indicators next to the charging inserts. The hearing aids will automatically be switched off when inserted into the charger.

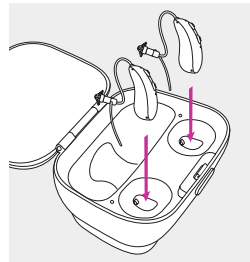

## 2

The indicator light will show the charging state of the battery until the hearing aid is fully charged. When fully charged the indicator light will remain on, i.e. solid green light.

The charging process will automatically stop when the batteries are fully charged, so the hearing aids can be safely left in the charger. It can take up to 3 hours to charge the hearing aids. The charger covers can be closed while charging.

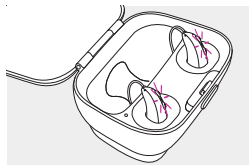

### Charging times

Indicator light	Charging state	Approx. charging times
● ● ●	0 – 10%	
● ● ●	11 – 80%	30 min (30%) 60 min (50%) 90 min (80%)
● ● ●	81 – 99%	
■	100%	3 h

3

Remove the hearing aids from the charging inserts by

1. pulling the hearing aids gently toward yourself and
2. lifting them out of the charger.

**i** Do not hold the tubes to remove the hearing aids from the charger as this can damage the tubes.

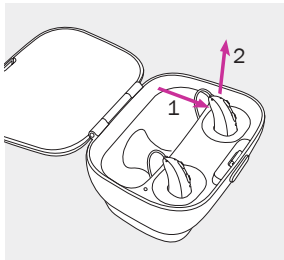

The hearing aid switches on automatically when removed from the charger. The indicator light starts blinking. The solid green light indicates the hearing aid is ready.

If you unplug the charger while the hearing aid is charging inside, please make sure to turn off the hearing aid to prevent discharge.

**i** Turn off your hearing aid before inserting it in the disconnected charger to store it.

## 4.2 Using the optional Easy Line Power Pack

1

Attach the Easy Line Power Pack to the bottom of the Kirkland Signature Charger Case and lock it.

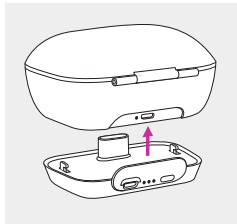

2

Plug in the micro-USB and connect to an external power supply. The Easy Line Power Pack and hearing aids will be charged at the same time. While connected to an external power supply, the Easy Line Power Pack indicator light will show the current battery charge status of the Easy Line Power Pack.

- ① Before using Easy Line Power Pack for the first time, it is recommended to charge it for 3 hours.
- ① The Easy Line Power Pack contains a built-in and non-removable rechargeable lithium-polymer battery.

micro-USB connection to external power source

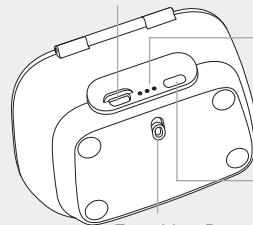

Indicator light battery status:

- 0%-29%
- 30%-59%
- 60%-100%

Battery check push button

Easy Line Power Pack lock and release

3

To check the remaining battery capacity of the Easy Line Power Pack, press the battery check push button. The indicator lights will show the status.

**i** Please ensure to charge the Easy Line Power Pack within operating temperature range: +5° to +40° Celsius (41° to 104° Fahrenheit)

## 5. Left & right hearing aid markings

There is a red or blue marking on the back of the hearing aid and on the speaker. This will tell you if it is a left or a right hearing aid.

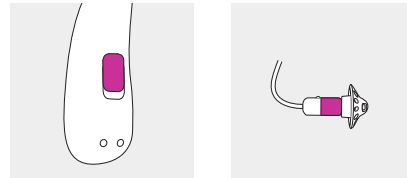

Blue marking for **left** hearing aid.

Red marking for **right** hearing aid.

## 6. Putting on the hearing aid

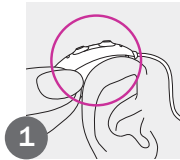

Place the hearing aid behind your ear.

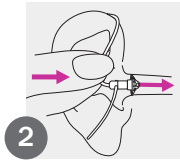

Insert the earpiece into your ear canal.

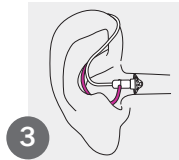

If there is an anchor attached to the earpiece, tuck it into the bowl of your ear to secure your hearing aid.

## 7. Removing the hearing aid

Pull on the bend of the tube and remove the hearing aid from behind your ear.

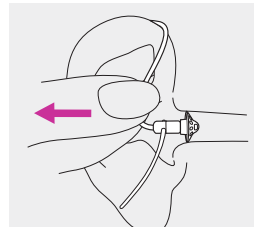



## 8. Multifunction button

The multifunction button has several functions.

It functions as an on/off switch, a volume control and/or a program change depending on the hearing aid programming. This is indicated in your individual “Hearing aid instructions”. Please ask your hearing care professional for a printout.

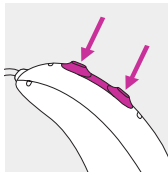

If the hearing aid is paired with a Bluetooth enabled phone, a short press on the upper or the lower part of the button will accept an incoming call and a long press will reject an incoming call — refer to chapter 13.

## 9. On/Off

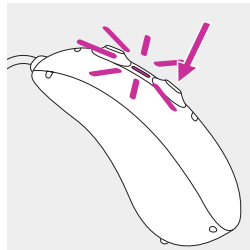

### Switch on hearing aid

The hearing aid is configured to switch on automatically when removed from the charger. If this function is not configured, firmly press and hold the lower part of the button for 3 seconds until the indicator light blinks. Wait until the solid green light indicates the hearing aid is ready.



## Switch off hearing aid

Press and hold the lower part of button for 3 seconds until the solid red light indicates the hearing is off.

	Blinking green	Hearing aid is switching on
	Solid red for 2 seconds	Hearing aid is switching off

**i** When you switch on the hearing aid you might hear a start-up melody.

## 10. Touch control

If paired with a Bluetooth enabled device, multiple functions can be accessed using touch control e.g. accept/end phone call, pause/resume streaming, start/stop voice assistant. This is indicated in your individual “Hearing aid instructions.”

To use this function tap the top of your ear twice.

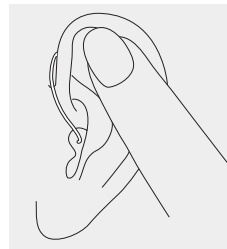

## 11. Connectivity overview

The illustration below shows the connectivity options available for your hearing aid.

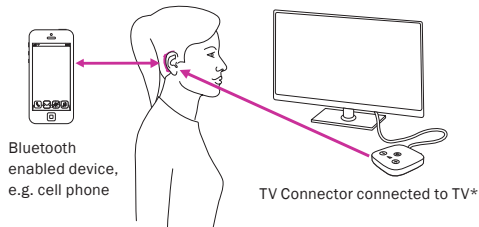

\* The TV Connector can be connected to any audio source such as a TV, PC or hi-fi system.

## 12. Initial pairing

### 12.1 Initial pairing to a Bluetooth enabled device

**i** It is only necessary to perform the pairing procedure once with each device featuring Bluetooth wireless technology. After the initial pairing, your hearing aids will connect automatically to the device. This can take up to 2 minutes.

1

On your device (e.g., a phone), ensure that Bluetooth wireless technology is enabled and search for Bluetooth enabled devices in the connectivity setting menu.

2

Switch on both hearing aids. You now have 3 minutes to pair your hearing aids with your device.

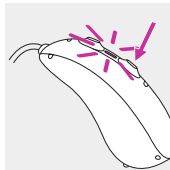

3

Your device shows a list of Bluetooth enabled devices. Select the hearing aid from the list to simultaneously pair both hearing aids. A beep confirms successful pairing.



For more information about pairing instructions for Bluetooth wireless technology, specific to some of the most popular phone manufacturers, go to: [www.KS10userportal.com](http://www.KS10userportal.com)

## 12.2 Connecting to the device

After your hearing aids have been paired to your device, they will automatically connect again when switched on.

- ❗ The connection will be maintained as long as the device remains ON and within range.
- ❗ Your hearing aid can be connected to up to two devices and paired to up to eight devices.

## 13. Phone calls

Your hearing aids connect directly with Bluetooth® enabled phones. When paired and connected to your phone, you will hear the caller's voice directly in your hearing aids. Your hearing aids pick up your voice through the microphones.

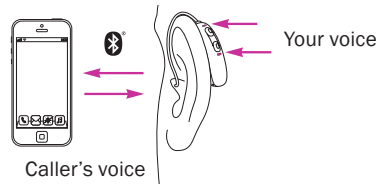

## 13.1 Making a call

Enter the phone number and press the dial button. You will hear the dial tone through your hearing aids. Your hearing aids pick up your voice through the microphones.

## 13.2 Accepting a call

When receiving a call, a calling notification will be heard in the hearing aids.

The call can be accepted by tapping the top of your ear twice, a short press on the upper or lower part of the multifunction button on the hearing aid (less than 2 seconds) or directly on your phone.

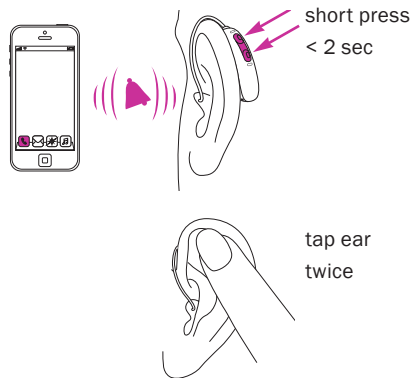

### 13.3 Ending a call

A call can be ended by tapping the top of your ear twice, a long press on the upper or lower part of the multifunction button on the hearing aid (more than 2 seconds) or directly on your phone.

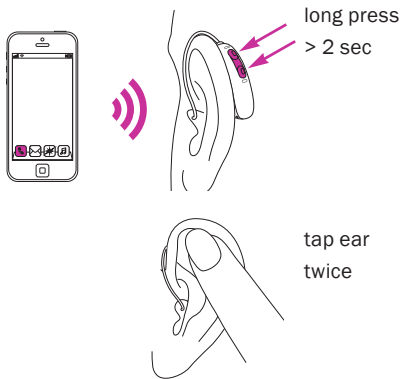

### 13.4 Rejecting a call

An incoming call can be rejected by a long press on the upper or lower part of the multi-function button on the hearing aid (more than 2 seconds) or directly on your phone.

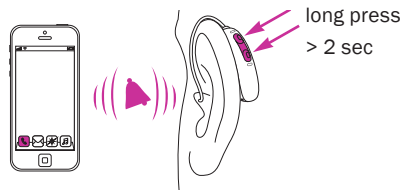



## 14. Flight mode

Your hearing aids operate between 2.4 GHz–2.48 GHz frequency range. When flying some operators require all devices to be switched into flight mode. Entering flight mode will not disable normal hearing aid functionality, only the Bluetooth connectivity functions.

### 14.1 Enter flight mode

To disable the wireless function and enter flight mode in each hearing aid:

1.		If the hearing aid is turned off, proceed to Step 2. If the hearing aid is on, turn it off by pressing and holding the lower part of the button for 3 seconds, until the indicator light turns solid red for 2 seconds, signifying that the hearing aid is switching off.
2.		Press and hold the lower part of the button. The green indicator light blinks when the hearing aid starts up.

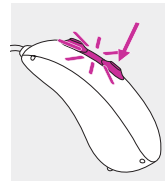



- |    |   |   |
|----|---|---|
| 3. |  | Keep pressing the button for 7 seconds, until the indicator light is solid orange, then release the button. The solid orange light indicates the hearing aid is in flight mode. |
|----|---|---|

In flight mode, your hearing aid cannot connect directly to your phone.

## 14.2 Exit flight mode

To enable the wireless function and exit flight mode in each hearing aid: Switch the hearing aid off and then on again — refer to chapter 9.

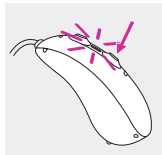

## 15. Rebooting your hearing aid

Use this technique if your hearing aid is in an error state. This will not remove or delete any program or settings.

1

Press the lower part of the button for at least 15 seconds. It does not matter if the hearing aid is switched on or off before you start pressing the button. There is no light or acoustic notification at the end of the 15 seconds.

2

Place the hearing aid in the power-connected Kirkland Signature Charger Case and wait until the indicator light blinks green. This can take up to 30 seconds. The hearing aid is now ready to use.

## 16. Operating, transport and storage conditions

The product is designed such that it functions without problems or restrictions if used as intended, unless otherwise noted in these user guides.

Please ensure to use, charge, transport and store the hearing aids and the Easy Line Power Pack according to the following conditions:

	Use	Charging	Transport	Storage
<b>Temperature</b>				
Maximum range	+5° to +40°C (41° to 104°F)	+5° to +40°C (41° to 104°F)	-20° to +60°C (-4° to 140°F)	-20° to +60°C (-4° to 140°F)
Recommended range	+5° to +40°C (41° to 104°F)	+7° to +32°C (45° to 90°F)	0° to +20°C (32° to 68°F)	0° to +20°C (32° to 68°F)
<b>Humidity</b>				
Maximum range	0% to 85% (non condensating)	0% to 85% (non condensating)	0% to 70%	0% to 70%
Recommended range	0% to 60% (non condensating)	0% to 60% (non condensating)	0% to 60%	0% to 60%
<b>Atmospheric pressure</b>	500 hPa to 1060 hPa	500 hPa to 1060 hPa	500 hPa to 1060 hPa	500 hPa to 1060 hPa

Please ensure to charge the hearing aids and the Easy Line Power Pack regularly during long-term storage.

These hearing aids are classified IP68 (depth of 1 meter for 60 minutes) and designed to be used in all daily life situations. Therefore you do not have to worry about getting the hearing aids exposed to a rain shower or sweat. However, these hearing aids are not intended to be used in water activities that includes chlorinated water, soap, salt water or other liquids with a chemical content.

## 17. Care and maintenance

Please use the following specifications as a guideline. Further information regarding product safety, see chapter 23.2.

### General information

Before using hair spray or applying cosmetics, you should remove your hearing aid from your ear, because these products may damage it.

Your hearing aids are resistant to water, sweat and dust under the following conditions:

- After exposure to water, sweat or dust, the hearing aid is cleaned and dried.
- The hearing aid is used and maintained as described in this user guide.



Always make sure that the hearing aids and charger are dry and clean before charging.

## Daily

**Hearing aid:** Inspect the earpiece for earwax and moisture deposit and clean the surfaces with a lint-free cloth. Never use cleaning agents such as household detergents, soap, etc. for cleaning your hearing aid. It is not recommended to rinse with water. If you need to clean your hearing aid intensively, ask your hearing care professional for advice and information on filters or drying capsules.

**Chargers:** Make sure that charger inserts are clean. Never use cleaning agents such as household detergents, soap, etc. for cleaning your charger.

## Weekly

**Hearing aid:** Clean the earpiece with a soft, damp cloth or with a special cleaning cloth for hearing aids. For more in-depth maintenance instructions or for more than basic cleaning, please see your hearing care professional. Clean the charging contacts on the hearing aid with a soft, damp cloth.

**Chargers:** Remove dust or dirt from the charger inserts.



Always make sure that the charger is disconnected from the power mains before cleaning.

## 18. Exchanging the earwax protection

Your hearing aid is equipped with an earwax protection to protect the speaker from earwax damage.

Please check the earwax protector regularly and exchange it if it looks dirty or if the hearing aid volume or sound quality is reduced. The earwax protection should be replaced every four to eight weeks. Refer to the Exchanging the earwax protection with CeruShield™ Disk in chapter 18.2.

### 18.1 Removing the earpiece from the speaker

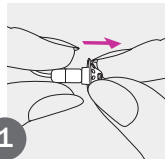

**1** Remove the earpiece from the speaker by holding the speaker in one hand and the earpiece in the other.

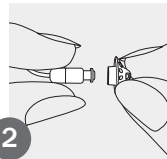

**2** Gently pull off the earpiece to remove.

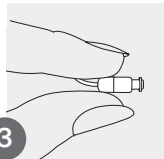

**3** Clean the speaker with a lint-free cloth.

## 18.2 Exchanging the earwax protection with CeruShield Disk

1

Gently rotate the CeruShield Disk in the direction indicated by the arrows until a free opening appears under the bin icon.

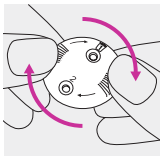

2

To remove a used earwax protector carefully insert the speaker into the free opening (under bin icon) until it clicks. After the click you will see the used earwax protector in the opening below the bin icon.

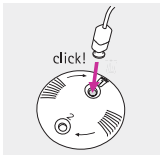

3

To insert a new earwax protector carefully insert the speaker into the opening where the new earwax protector is visible (opposite the bin icon) until it clicks. After the click you will see the opening below is empty and the new earwax protector sits in the speaker.



18.3 Attaching the earpiece to the speaker

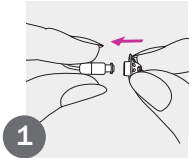

1 Hold the speaker in one hand and the earpiece in the other.

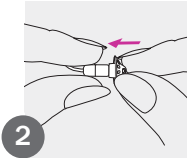

2 Slide the earpiece over the speaker sound outlet.

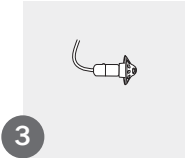

3 The speaker and the earpiece should fit perfectly together.

19. Service and warranty

Serial numbers	Hearing aid	Receiver unit
Left:		
Right:		

Serial numbers
Kirkland Signature Charger Case:
Easy Line Power Pack:

Service dates	
1:	4:
2:	5:
3:	6:



## Warranty

---

Date of purchase:

---

Warranty period in months:

## 20. Compliance information

### Europe:

---

#### Declaration of Conformity

Hereby the manufacturer declares that this product meets the requirements of the Medical Devices Directive 93/42/EEC as well as the Radio Equipment Directive 2014/53/EU. The full text of the EU Declaration of Conformity can be obtained from the manufacturer: [www.sonova.com/en/certificates](http://www.sonova.com/en/certificates)

### Australia/New Zealand:

---



**R-NZ**

Indicates a device's compliance with applicable Radio Spectrum Management's (RSM) and Australian Communications and Media Authority (ACMA) regulatory arrangements for the legal sale in New Zealand and Australia. The compliance label R-NZ is for radio products supplied in the New Zealand market under conformity level A1.

The wireless model listed on page 2 is certified under:

### KS 10.0 / KS 10.0 Demo / KS 10.0 Loaner

---

USA

**FCC ID:** KWC-MRP

Canada

**IC:** 2262A-MRP

### Notice 1:

This device complies with Part 15 of the FCC Rules and with RSS-210 of Industry Canada. Operation is subject to the following two conditions:

- 1) this device may not cause harmful interference, and
- 2) this device must accept any interference received, including interference that may cause undesired operation.

### Notice 2:

Changes or modifications made to this device not expressly approved by the manufacturer may void the FCC authorization to operate this device.

**Notice 3:**

This device has been tested and found to comply with the limits for a Class B digital device, pursuant to Part 15 of the FCC Rules and ICES-003 of Industry Canada.

These limits are designed to provide reasonable protection against harmful interference in a residential installation. This device generates, uses and can radiate radio frequency energy and, if not installed and used in accordance with the instructions, may cause harmful interference to radio communications. However, there is no guarantee that interference will not occur in a particular installation. If this device does cause harmful interference to radio or television reception, which can be determined by turning the equipment off and

on, the user is encouraged to try to correct the interference by one or more of the following measures:

- Reorient or relocate the receiving antenna.
- Increase the separation between the device and receiver.
- Connect the device into an outlet on a circuit different from that to which the receiver is connected.
- Consult the dealer or an experienced radio/TV technician for help.

## Radio information of your wireless hearing aid

Antenna type	Resonant loop antenna
Operation frequency	2.4 GHz – 2.48 GHz
Modulation	GFSK, Pi/4 DPSK, GMSK
Radiated power	< 2.5mW
Bluetooth	
Range	~1m
Bluetooth	4.2 Dual-Mode
Profiles supported	HFP (Hands-free profile), A2DP

## Compliance with emission and immunity standards

Emission standards	EN 60601-1-2:2015
	IEC 60601-1-2:2014
	EN 55011:2009+A1
	CISPR11:2009/AMD1:2010
	CISPR22:1997
	CISPR32:2012
	ISO 7637-2:2011
	CISPR25:2016
	EN 55025:2017
Immunity standards	EN 60601-1-2:2015
	IEC 60601-1-2:2014
	EN 61000-4-2:2009
	IEC 61000-4-2:2008

EN 61000-4-3:2006+A1+A2
IEC 61000-4-3:2006+A1+A2
EN 61000-4-4:2012
IEC 61000-4-4:2012
EN 61000-4-5:2014
IEC 61000-4-5:2014
EN 61000-4-6:2014
IEC 61000-4-6:2013
EN 61000-4-8:2010
IEC 61000-4-8:2009
EN 61000-4-11:2004
IEC 61000-4-11:2004
IEC 60601-1 (§ 4.10.2):2005
ISO 7637-2:2011

## 21. Information and description of symbols



With the CE symbol, Sonova AG confirms that this product – including accessories – meets the requirements of the Medical Devices Directive 93/42/EEC as well as the Radio Equipment Directive 2014/53/EU. The numbers after the CE symbol correspond to the code of certified institutions that were consulted under the above-mentioned directives.



With the CE symbol, Sonova AG confirms that the Kirkland Signature Charger Case meets the requirements of the Medical Devices Regulation (EU) 2017/745.



This symbol indicates that the products described in these user instructions adhere to the requirements for an applied part of Type B of EN 60601-1. The surface of the hearing aid is specified as an applied part of Type B.

---



Indicates the Kirkland Signature Charger Case manufacturer, as defined in Medical Devices Regulation (EU) 2017/745.

---



Indicates the Authorized representative in the European Community. The EC REP is also the importer to the European Union.

---



This symbol indicates that it is important for the user to read and take into account the relevant information in these user guides.

---



This symbol indicates that it is important for the user to pay attention to the relevant warning notices in these user guides.

---



Important information for handling and product safety.

---



This symbol confers that the electromagnetic interference from the device is under limits approved by the US Federal Communications Commission.

---

 **Bluetooth®** The Bluetooth® word mark and logos are registered trademarks owned by Bluetooth SIG, Inc. and any use of such marks by the manufacturer is under license. Other trademarks and trade names are those of their respective owners.

---



Japanese mark for certified radio equipment.

---

---

**Operating  
conditions**

The product is designed such that it functions without problems or restrictions if used as intended, unless otherwise noted in these user guides. The hearing aids are classified IP68 (depth of 1 meter for 60 minutes) and designed to be used in all daily life situations. Therefore you do not have to worry about getting the hearing aids exposed to a rain shower or sweat. However, the hearing aid is not intended to be used in water activities that includes chlorinated water, soap, salt water or other liquids with a chemical content.



Indicates the manufacturer's serial number so that a specific medical device can be identified.

---



Indicates the manufacturer's catalogue number so that the medical device can be identified.

---



Indicates that the device is a medical device.

---



This symbol indicates that it is important for the user to read and take into account the relevant information in this user guide.

---



Temperature during transportation and storage:  
-20° to +60° Celsius (-4° to +140° Fahrenheit).

---



Humidity during storage: 0% to 70%, if not in use. See instruction in chapter 23.2 regarding drying the hearing aid after use.

---



Atmospheric pressure during transportation and storage:  
500 hPa to 1060 hPa

---



During transportation keep dry.

---





The symbol with the crossed-out garbage bin is to make you aware that this hearing aid, as well as the charger and Easy Line Power Pack, may not be thrown away as normal household waste. Please dispose of old or unused hearing aids and charger, at waste disposal sites intended for electronic waste, or give your hearing aid and charger to your hearing care professional for disposal. Proper disposal protects the environment and health.

---

### Symbols applicable to the European power supply only

---



Power supply with double isolation.

---



Device designed for indoor use only.

---



Safety isolating transformer, short circuit proof.

---

# 22. Troubleshooting

Problem	Causes
Hearing aid not functioning	Speaker/earpiece blocked
	Hearing aid switched off
	Battery fully discharged
Hearing aid whistles	Hearing aid not inserted correctly into ear
	Cerumen in ear canal
Hearing aid too loud	Volume too loud
Hearing aid not loud enough or distorted	Volume too low
	Low battery
	Speaker/earpiece blocked
	Hearing has changed

What to do
Clean speaker opening/earpiece
Press lower part of multi-function button for 3 seconds (chapter 9)
Charge hearing aid (chapter 4)
Insert hearing aid correctly (chapter 6)
Contact your ENT/GP or hearing care professional
Decrease volume if volume control available (chapter 8)
Increase volume if volume control available (chapter 8)
Charge hearing aid (chapter 4)
Clean speaker opening/earpiece
Contact your hearing care professional

Problem	Causes
Hearing aid plays two beeps	Indication for low battery
Hearing aid will not switch on	Battery fully discharged
	Button was inadvertently deactivated by pressing the button longer than 15 seconds
Indicator light on hearing aid does not light up when hearing aid placed in charging inserts	Hearing aid not inserted correctly into charger
	Charger not connected to power source
	Battery fully discharged
Indicator light on hearing aid is solid red while hearing aid is in the charger	Dirty charging contacts
	Hearing aid is out of its operating temperature range
	Faulty battery

What to do
Charge hearing aid (chapter 4)
Charge hearing aid (chapter 4)
Perform step 2 of the rebooting process (chapter 15)
Insert hearing aid correctly into charger (chapter 4)
Connect charger to external power supply (chapter 3)
Wait three hours after placing hearing aid in charger, regardless of LED behavior
Clean the contacts of the hearing aid and the charger
Warm hearing aid up. Operating temperature range is +5° to +40° Celsius (+41° to +104° Fahrenheit)
Contact your hearing care professional

Problem	Causes
Indicator light on hearing aid switches off when hearing aid is removed from charger	“Auto On” feature is disabled
Indicator light on hearing aid remains solid green after removal from charger	Indicator light on hearing aid was red when hearing aid was placed into the charger
Battery does not last the whole day	Shortened battery life
Phone call function does not work	Hearing aid is in flight mode Hearing aid not paired to the phone
Charging does not start (no Easy Line Power Pack used)	Charger not connected to power supply Hearing aid not inserted correctly into charger

What to do
Switch on the hearing aid (chapter 9)
Reboot the hearing aid (chapter 15)
Contact your hearing care professional. A battery replacement may be required.
Switch hearing aid off and then on again (chapter 14.2)
Pair hearing aid to the phone (chapter 12)
Connect charger to power supply or Easy Line Power Pack (chapter 4.2)
Insert hearing aid correctly into charger (chapter 4.1)

**Problem**

Charging does not start when using Easy Line Power Pack

**Causes**

Easy Line Power Pack discharged

**What to do**

Charge Easy Line Power Pack (chapter 4.2)

Please check [www.KS10userportal.com](http://www.KS10userportal.com) for further information.

**i** If the problem persists, contact your hearing care professional for assistance.

## 23. Important safety information

Please read the information on the following pages before using your hearing aid.

Intended use:

The hearing aid is intended to amplify and transmit sound to the ear and thereby compensate for impaired hearing. The Tinnitus feature is intended for use by people with tinnitus who also desire amplification. It provides supplementary noise stimulation which can help defocus the user's attention from their tinnitus.

Indications:

Presence of hearing loss. Presence of hearing loss in combination with tinnitus.

Contraindications:

Evidence of active or chronic middle or outer ear pathology, chronic drainage or discharge, evidence of chronic inflammation.

A hearing aid will not restore normal hearing and will not prevent or improve a hearing impairment resulting from organic conditions. Infrequent use of a hearing aid does not permit a user to attain full benefit from it. The use of a hearing aid is only part of hearing habilitation and may need to be supplemented by auditory training and instruction in lipreading.

The hearing aid is suitable for the home healthcare environment and due to their portability it may happen that it is used in professional healthcare facility environment like physician offices, dental offices etc.

Target population:

The target population is primarily the adult population over 18 years of age. This product may also be used with children 36 months of age or older. Mentally challenged users will require constant supervision by a caregiver.



The target group for the Tinnitus feature are adults 18 years of age or older with tinnitus who also desire amplification.

Any serious incident that has occurred in relation to the hearing aid, should be reported to the manufacturer representative and the competent authority of the state of residence. The serious incident is described as any incident that directly or indirectly led, might have led or might lead to any of the following:

- a) the death of a patient, user or other person
- b) the temporary or permanent serious deterioration of a patient's, user's or other person's state of health
- c) a serious public health threat

To report an unexpected operation or event, please contact the manufacturer or a representative.

## 23.1 Hazard warnings

-  The rechargeable hearing aid contains lithium-ion batteries and the Easy Line Power Pack contains a lithium-polymer battery that can be taken onto airplanes as carry-on luggage. The Easy Line Power Pack cannot be placed in the checked-in baggage and can only be placed in the carry-on luggage.
-  Your hearing aids operate between 2.4 GHz–2.48 GHz frequency range. When flying please check if flight operator requires devices to be switched into flight mode, see chapter 14.



- ⚠ The hearing aids (specially programmed for each hearing loss) must only be used by the intended person. They should not be used by any other person as they could damage hearing.
- ⚠ Changes or modifications to the hearing aid that were not explicitly approved by the manufacturer are not permitted. Such changes may damage your ear or the hearing aid.
- ⚠ Do not use the hearing aids and charging accessories in explosive areas (mines or industrial areas with danger of explosions, oxygen rich environments or areas where flammable anesthetics are handled) or where electronic equipment is prohibited.

- ⚠ If you feel pain in or behind your ear, if it is inflamed or if skin irritation and accelerated accumulations of earwax occur, please check with your hearing care professional or physician.
- ⚠ In very rare cases, the dome can remain in your ear canal when removing the hearing tube from the ear. In the unlikely case that the dome does get stuck in your ear canal, it is strongly recommended to see a physician for safe removal. To prevent pushing the dome towards the eardrum, never try to re-insert the speaker into the ear canal.

- ⚠ Hearing programs in the directional microphone mode reduce background noises. Please be aware that warning signals or noises coming from behind, e. g. cars, are partially or entirely suppressed.
- ⚠ This hearing aid is not for children below 36 months. The usage of this device by children and individuals with cognitive impairment should be supervised at all times to ensure their safety. The hearing aid is a small device and contains small parts. Do not leave children and individuals with cognitive impairment unsupervised with this hearing aid. If swallowed, consult a physician or hospital immediately as the hearing aid or its parts can cause choking!

- ⚠ Keep the Kirkland Signature Charger Case out of reach of children, individuals with cognitive impairment and pets.
- ⚠ Only authorized personnel are allowed to open the Easy Line Power Pack due to possible electrical hazard.
- ⚠ Do not cover the whole Kirkland Signature Charger Case while charging, e.g. with a cloth, etc.
- ⚠ The following is only applicable for persons with active implantable medical devices (i.e. pacemakers, defibrillators, etc.):
  - Keep the wireless hearing aid at least 15 cm (6 inches) away from the active implant. If you experience any interference, do not use the wireless hearing aids and contact the

manufacturer of the active implant. Please, note that interference can also be caused by power lines, electrostatic discharge, airport metal detectors etc.

- Keep magnets (e.g., battery handling tool, EasyPhone magnet, etc.) at least 15 cm (6 inches) away from the active implant.
- If using a wireless accessory manufactured by Sonova AG, consult the chapter “Important safety information” in your wireless accessory user guide.

 Use of this equipment adjacent to or stacked with other equipment should be avoided because it could result in improper operation. If such use is necessary, this equipment and the other equipment should be observed to verify that they are operating normally.

 Use of accessories, transducers and cables other than those specified or provided by the manufacturer of this equipment could result in increased electromagnetic emissions or decreased electromagnetic immunity of this equipment and result in improper operation.

 Portable RF communications equipment (including peripherals such as antenna cables and external antennas) should be used no closer than 30 cm (12 inches) to any part of the hearing aids, including cables specified by the manufacturer. Otherwise, degradation of the performance of this equipment could result.

 The USB port of the charger is to be used for the described purpose only.

- ⚠ For charger, use only EN60950-1 and/or EN60601-1 certified equipment with an output rating of 5 VDC. Min. 500 mA.
- ⚠ Hearing aids should not be fitted with domes / wax protection systems when used by clients with perforated eardrums, inflamed ear canals or otherwise exposed middle ear cavities. In these cases, we recommend the use of a custom earpiece. In the unlikely case that any part of this product should remain in the ear canal, it is strongly recommended to see a medical specialist for safe removal.

- ⚠ Avoid strong physical impacts to the ear when wearing a hearing aid with customized earpiece. The stability of customized earpieces is designed for normal use. A strong physical impact to the ear (e.g. during sports) may cause the customized earpiece to break. This may lead to perforation of the ear canal or eardrum.
- ⚠ After mechanical stress or shock to the customized earpiece, please ensure that it is intact before placing it in the ear.

## 23.2 Information on product safety

- ① These hearing aids are water resistant and not waterproof. They are designed to withstand normal activities and occasional accidental exposure to extreme conditions. Never immerse your hearing aid in water! These hearing aids are not specifically designed for extended periods of water submersion on a continual basis, that is worn in activities such as swimming or bathing. Always remove your hearing aid before these activities, as the hearing aid contains sensitive electronic parts.
- ① Never wash the microphone inputs. Doing so could cause it to lose its special acoustic features.

- ① Protect your hearing aid and charging accessories from heat (never leave near a window or in the car). Never use a microwave or other heating devices to dry your hearing aid or charging accessories (due to risk of fire or explosion). Ask your hearing care professional about suitable drying methods.
- ① Do not place the charging accessories close to an induction cooking surface. Conductive structures inside the charging accessories could absorb inductive energy resulting in thermal destruction.

- ① The dome should be changed every three months or when it becomes stiff or brittle. This is to prevent the dome from detaching from the tube spout during insertion into or removal from the ear.
- ① Do not drop your hearing aid or charging accessories! Dropping onto a hard surface can damage your hearing aid or charging accessories.
- ① Charger, Easy Line Power Pack and power supply must be protected against shocks. If the charger, Easy Line Power Pack or power supply is damaged after a shock, the devices must not be used anymore.

- ① Special medical or dental examination including radiation described below, may adversely affect the correct functioning of your hearing aids. Remove and keep them outside the examination room/area before undergoing:
  - Medical or dental examination with X-ray (also CT scan).
  - Medical examinations with MRI/NMRI scans, generating magnetic fields.

Hearing aids don't need to be removed when passing security gates (airports etc.). If X-ray is used at all, it will be in very low doses, and will not affect the hearing aids.

- ① Do not use your hearing aid in areas where electronic equipment is prohibited.

- ① The hearing aids have to be dry before charging. Otherwise the charging reliability cannot be guaranteed.
- ① Only use the approved charger and Easy Line Power Pack described in this user guide for charging your hearing aids, otherwise the devices may be damaged.
- ① Your hearing aid(s) contain a lithium-ion battery and the Easy Line Power Pack contains a lithium-polymer battery, both with a Watt hour rating <20 Wh which have been tested according to UN 38.3 of the “UN Manual of Tests and Criteria” and should be shipped in accordance with all the rules and regulations on the safe shipment of lithium-ion and lithium-polymer batteries.

## 24. Important information: Cellphones

Some hearing aid users have reported a buzzing sound in their hearing aids when they are using cellphones. According to the ANSI 63.19 (American National Standard Methods of Measurement of Compatibility between Wireless Communications Devices and Hearing Instruments) standard, the compatibility of a particular hearing aid and cellphone can be predicted by adding the rating for the hearing aid immunity to the rating for the cellphone emissions. The sum of the hearing aid rating (e.g., M2/T2=2) and the telephone rating (e.g., M3/T3=3) is 5, and any combination that equals 5 will provide “normal use”; a sum of 6 or greater would indicate “excellent performance.” The equipment performance measurements,

categories and system classifications are based upon the best information available but cannot guarantee that all users will be satisfied. The immunity of this hearing aid is at least M2/T2.

**Note:** The performance of individual hearing aids may vary with individual cellphones. Therefore, please try the hearing aid with your cellphone or, if you are purchasing a new phone, be sure to try it with your hearing aid prior to purchase. For additional guidance, please ask your hearing care professional for the booklet titled “hearing aid compatibility with digital wireless cellphones.”

## 25. For the U.S. market only, complies with the FDA regulations

### Warning to Hearing Aid Dispensers

A hearing aid dispenser should advise a prospective hearing aid user to consult promptly with a licensed physician (preferably an ear specialist) before dispensing a hearing aid if the hearing aid dispenser determines through inquiry, actual observation, or review of any other available information concerning the prospective user, that the prospective user has any of the following conditions:

- (i) Visible congenital or traumatic deformity of the ear.



- (ii) History of active drainage from the ear within the previous 90 days.
- (iii) History of sudden or rapidly progressive hearing loss within the previous 90 days.
- (iv) Acute or chronic dizziness.
- (v) Unilateral hearing loss of sudden or recent onset within the previous 90 days.
- (vi) Audiometric air-bone gap equal to or greater than 15 decibels at 500 hertz (Hz), 1,000 Hz and 2,000 Hz.
- (vii) Visible evidence of significant cerumen accumulation or a foreign body in the ear canal.

- (viii) Pain or discomfort in the ear. Special care should be exercised in selecting and fitting a hearing aid whose maximum sound pressure level exceeds 132 decibels because there may be risk of impairing the remaining hearing of the hearing aid user. (This provision is required only for those hearing aids with a maximum sound pressure capability greater than 132 decibels (dB).)

### **Important Notice for Prospective Hearing Aid Users**

Good health practice requires that a person with a hearing loss have a medical evaluation by a licensed physician (preferably a physician who specializes in diseases of the ear) before purchasing a hearing aid. Licensed physicians who specialize in diseases of the ear are often referred to as otolaryngologists, otologists or

otorhinolaryngologists. The purpose of medical evaluation is to assure that all medically treatable conditions that may affect hearing are identified and treated before the hearing aid is purchased.

Following the medical evaluation, the physician will give you a written statement that states that your hearing loss has been medically evaluated and that you may be considered a candidate for a hearing aid. The physician will refer you to an audiologist or a hearing aid dispenser, as appropriate, for a hearing aid evaluation.

The audiologist or hearing aid dispenser will conduct a hearing aid evaluation to assess your ability to hear with and without a hearing aid. The hearing aid evaluation will enable the audiologist or dispenser to select and fit a hearing aid to your individual needs.

If you have reservations about your ability to adapt to amplification, you should inquire about the availability of a trial-rental or purchase-option program. Many hearing aid dispensers now offer programs that permit you to wear a hearing aid for a period of time for a nominal fee after which you may decide if you want to purchase the hearing aid.

Federal law restricts the sale of hearing aids to those individuals who have obtained a medical evaluation from a licensed physician. Federal law permits a fully informed adult to sign a waiver statement declining the medical evaluation for religious or personal beliefs that preclude consultation with a physician. The exercise of such a waiver is not in your best health interest and its use is strongly discouraged.

## Children with Hearing Loss

In addition to seeing a physician for a medical evaluation, a child with a hearing loss should be directed to an audiologist for evaluation and rehabilitation since hearing loss may cause problems in language development and the educational and social growth of a child.

An audiologist is qualified by training and experience to assist in the evaluation and rehabilitation of a child with a hearing loss.

DISTRIBUTED BY:  
COSTCO WHOLESALE CORPORATION  
P.O. BOX 34535  
SEATTLE, WA 98124-1535  
USA  
1-800-774-2678  
WWW.COSTCO.COM

COSTCO WHOLESALE UK LTD /  
COSTCO ONLINE UK LTD  
HARTSPRING LANE  
WATFORD, HERTS  
WD25 8JS  
UNITED KINGDOM  
01923 213113  
WWW.COSTCO.CO.UK

COSTCO WHOLESALE SPAIN S.L.U.  
POLÍGONO EMPRESARIAL LOS GAVILANES  
C/ AGUSTÍN DE BETANCOURT, 17  
28906 GETAFE (MADRID) ESPAÑA  
NIF: B86509460  
900 111 155  
WWW.COSTCO.ES

COSTCO FRANCE  
1 AVENUE DE BRÉHAT  
91140 VILLEBON-SUR-YVETTE  
FRANCE  
01 80 45 01 10  
WWW.COSTCO.FR

COSTCO WHOLESALE ICELAND EHF.  
KAUPTÚN 3-7, 210 GARDABAER  
ICELAND  
WWW.COSTCO.IS

COSTCO WHOLESALE AUSTRALIA PTY LTD  
17-21 PARRAMATTA ROAD  
LIDCOMBE NSW 2141  
AUSTRALIA  
WWW.COSTCO.COM.AU



COSTCO WHOLESALE KOREA, LTD.  
40, ILJIK-RO, GWANGMYEONG-SI, GYEONGGI-DO, 14347, KOREA  
1899-9900 • WWW.COSTCO.CO.KR

COSTCO PRESIDENT TAIWAN, INC.  
NO. 656 CHUNG-HWA 5TH ROAD  
KAOHSIUNG, TAIWAN\*  
COMPANY TAX ID: 96972798  
449-9909 OR 02-449-9909 (IF CELLPHONE)  
WWW.COSTCO.COM.TW  
\*ANY REFERENCE TO "COUNTRY" SHALL MEAN  
COUNTRY/REGION AS APPLICABLE

COSTCO WHOLESALE JAPAN LTD, 3-1-4 IKEGAMI-SHINCHO  
KAWASAKI-KU, KAWASAKI-SHI, KANAGAWA 210-0832 JAPAN  
0570-032600 • WWW.COSTCO.CO.JP

20KS13055d

If you're not completely satisfied with this Kirkland Signature product, your money will be refunded.

Si ce produit Kirkland Signature ne vous donne pas entière satisfaction, nous vous le rembourserons.

Si no queda completamente satisfecho con su producto Kirkland Signature, se le devolverá el dinero.

For UK only: This does not affect your statutory rights.  
Pour le Royaume-Uni seulement : ceci n'affecte pas vos droits légaux.

Para Reino Unido solamente: Esto no afecta sus derechos legales.

Your hearing care professional:



**Manufacturer:**

Sonova AG

Laubisrütistrasse 28

CH-8712 Stäfa

Switzerland

029-0859-03/V1.01/2021-02/hc © 2021 Sonova AG. All rights reserved.

